

ASSEMBLY GUIDE

620MM STANDARD WALL - L SHAPED CORNER

REQUIRED TOOLS:

Cross Head Screw Driver
Drill & Drill Bits
Hammer
Spirit Level
PVA Wood Glue
Pliers

REQUIRED COMPONENTS:

12x Wooden Dowels	3x Hanging Brackets
22x Metal Dowels	3x Wall Plates
12x Cams	
14x Shelf Brackets	
10x Round head screws for the back panel	
6x 30mm Screws for the hanging brackets	

WARNING

This product should be assembled by a competent individual and according to the above instructions only. Failure to correctly install the product could result in it being dangerous. Please ensure that all components are included and if not, or if you have any other questions, please contact us by sending an email to; sales@tradekitchensforall.co.uk

This product may contain small parts and solvent, which should be kept out of the way of children at all times. Seek immediate medical attention if any solvent comes into contact with eyes or is swallowed.

1.



Before assembly place on a solid flat surface and make sure that you have all the correct tools.

Insert the wooden dowels into the two inner holes provided at either end of the top and bottom panels. Prior to inserting apply a small amount of wood PVA glue in the hole.

2.

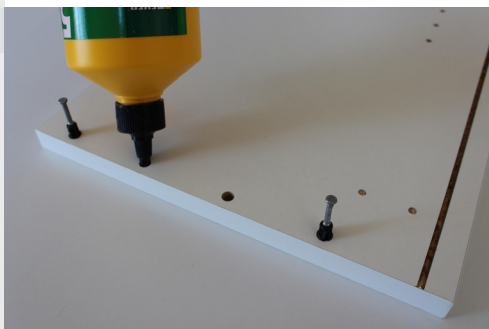

Proceed to insert the metal dowels into the outer two holes on the side panels at both ends.

3.



Insert the bottom and top panels into the corresponding holes and metal dowels on the side panels.

At this stage be sure that the white edges of the top and bottom panels are facing the front of the cabinet. Then proceed to tighten the cams with a cross head screw driver.

4.



Attach the cabinet hanging brackets with the 30mm screws provided at the top of the cabinet, where there are pre-positioned holes provided on the side panels for your guidance.



Once you have done one side panel be sure to insert the back panel into the groove provided and then continue the procedure with the remaining side panel.

5.



Use the round head screws to attach the back panel to the top and bottom panels of the cabinet.

Insert screws here

6.



Using the metal dowels insert them into the pre cut holes on the outer edge of the largest cabinet, where the two will meet. Now place this cabinet aside and begin construction of the smaller cabinet.

7.



Again using the metal dowels insert one into each of the pre cut holes within the groove on one of the side panels.

8.



On the top edge of the side panel, insert a further two metal dowels into the two outside holes and two wooden dowels into the inner holes.

9.



Insert the bottom and top panels into the corresponding holes and dowels on the side panels.

At this stage be sure that the white edges of the top and bottom panels are facing the front of the cabinet and proceed to tighten the cams with a cross head screw driver.

10.



Once the top and bottom panels are fixed in position take the remaining side panel and insert into the pre cut groove, making sure again at this stage that the white edge is facing the front of the cabinet. Proceed to tighten the cams with a cross head screw driver.

11.



To finish fixing the side panel into position fix three 30mm screws along the top and bottom edges of the panel.

12.



The larger and small cabinets can now be fixed together. Insert the metal dowels into the holes on the larger cabinet, as shown and insert into the corresponding holes on the smaller of the two cabinets.

13.



Again proceed to tighten the cams with a cross head screw driver.

14.



To assemble the shelves take one large and one small sized shelf piece. Insert two metal dowels into the pre cut holes in the larger of the two shelf pieces. Connect the two pieces together as per diagram and finish by tightening the cams.

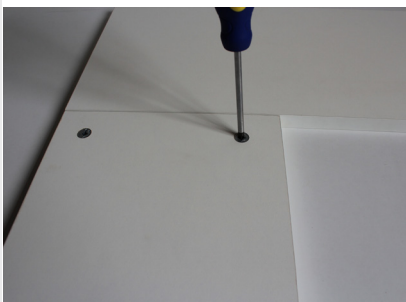

15.



Position the shelf brackets into the holes provided at your desired height.

16.



The finished product.

WHEN FIXING TO THE WALL:

Attatch the wall hanging plate using appropriate fixing to secure to the wall, depending on wall type.